

FLAT

Design by Ichiro Iwasaki.

Reference

5970.

Application

Table Lamps

Installation type

Surface

Description

The Flat table lamp offers multiple functionality; material and light are integrated in a single body. The Flat collection contains various planes of light that rise up to become self-illuminating supports.

Diffuser

Polycarbonate diffuser

Materials

Body: Steel

Base: Steel

Head: Aluminium

Reflector: Aluminium

Finish



5970-11 Black (NCS S 8500N)



5970-37 Terra Red (NCS S 4040-Y70R)



5970-47 Green L1 (NCS S 4005-G80Y)

Sketch

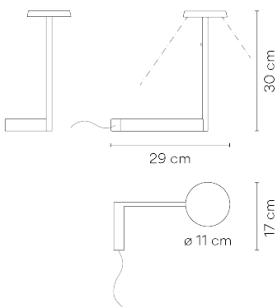

Electrical characteristics

1 x LED PLATE 7W 400mA

Total 7.0 W



VIBIA



Light source: 2700K CRI >90 1200 lm 171 lm/W

Driver included: CC - Constant Current 400 mA 100-240V 50/60Hz

Electronic dimming PUSH

Technical characteristics

- 24V transformer at plug

Physical characteristics

0 Box / 0.00 x 0.00 x 0.00 m. / Vol. 0.0000 m³ /

Gross weight 0.0 kg. / Net weight 0.0 kg.

Installation and assembly

Please, see the installation manual

Light distribution

General lighting

Lamp for general lighting that equally distributes the light in all directions.



Photometric data

Certificates

